

IFR18650

Cell Specifications:

- Nominal Operating Voltage.....3.2 VDC
- Capacity.....1450 mAh
(Constant C/2 Current to 3.65 Volt limit, then Constant Voltage (3.65V) with floating current taper to C/20, then discharge at C/5 to 2.5V)
- Initial Impedance(measured @30% SOC, 1 kHz AC).....65 mOhm
- Diameter..... 18.3 ± 0.05 mm
- Length..... 65.0 ± 0.3 mm
- Weight.....38 g
- Charge Temperature Range.....0 to +45°C
- Discharge Temperature Range.....-20 to +60°C
- Storage Temperature Range.....-40 to +45°C

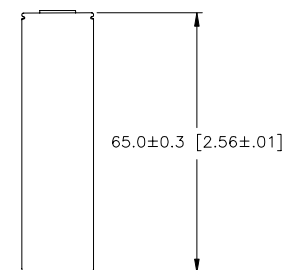
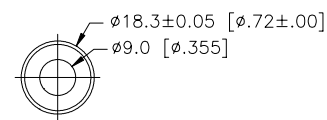

DIMENSIONS IN MM

Discharge Rate Characteristics

Charge: C/2 to 3.65V (CC-CV)
Discharge: as indicated

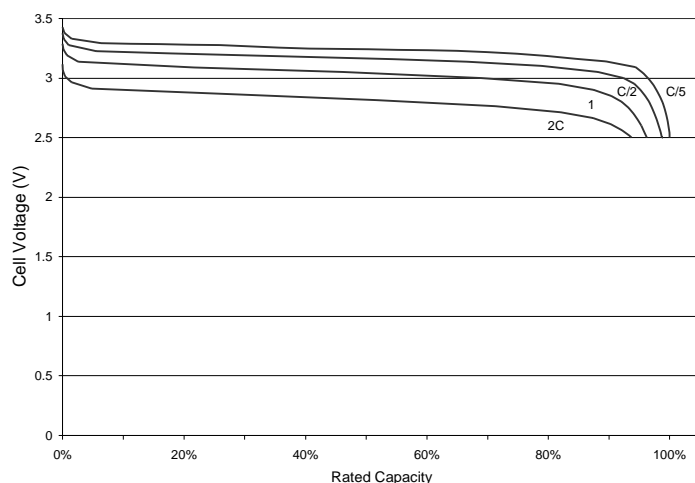

Discharge Temperature Characteristics

Charge: C/2 to 3.65V (CC-CV)
Discharge: C/5 as indicated

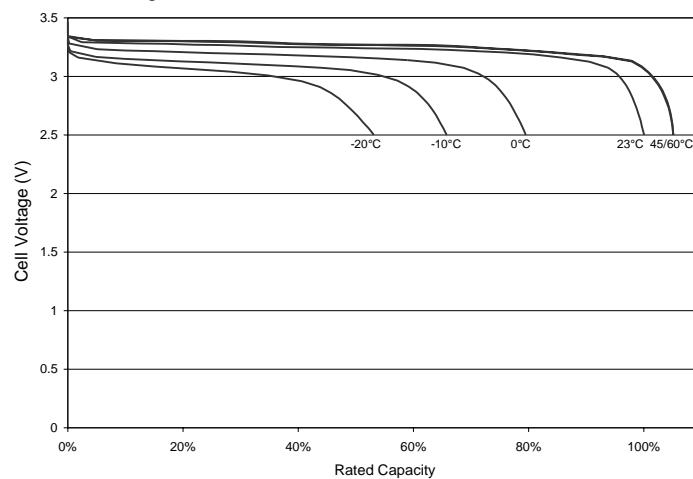

Cycle Life Characteristics

Charge: C/2 to 3.65V (CC-CV)
Discharge: C/2 to 2.5V

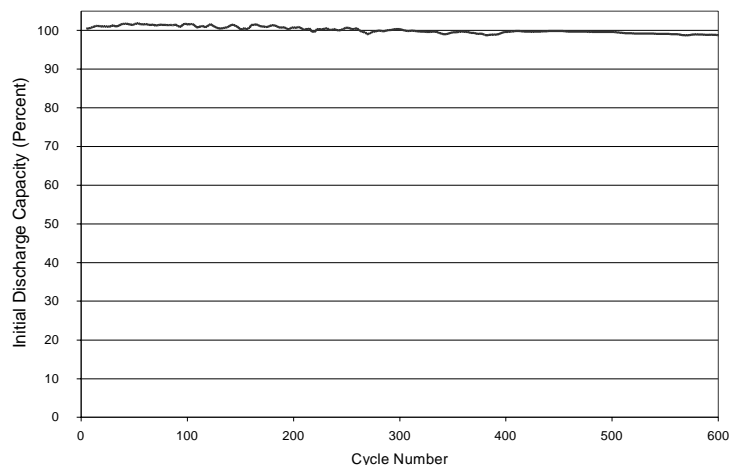

Service Life for Standby Applications

Grid connected at 100% SOC

